

Anarchist Tool chest

WWAP GROUP PROJECT



Lessons learned

- Patience, take your time
- Marking out dovetails with a compass
- Sharp chisels

New or refined skills?

- Refined on dovetailing
- Floating panel lid

Problems and overcoming them:

- Trimming the lid flush with chest with a router
- Always check that the bearing is secure
- Had to make the lid a bit smaller
- Could not add a lock anymore

Is it a worth while project?

- Yes
- Great dovetail exercise
- Size is a bit large – maybe a smaller counter top size will get more interest

Drawings and Planning:

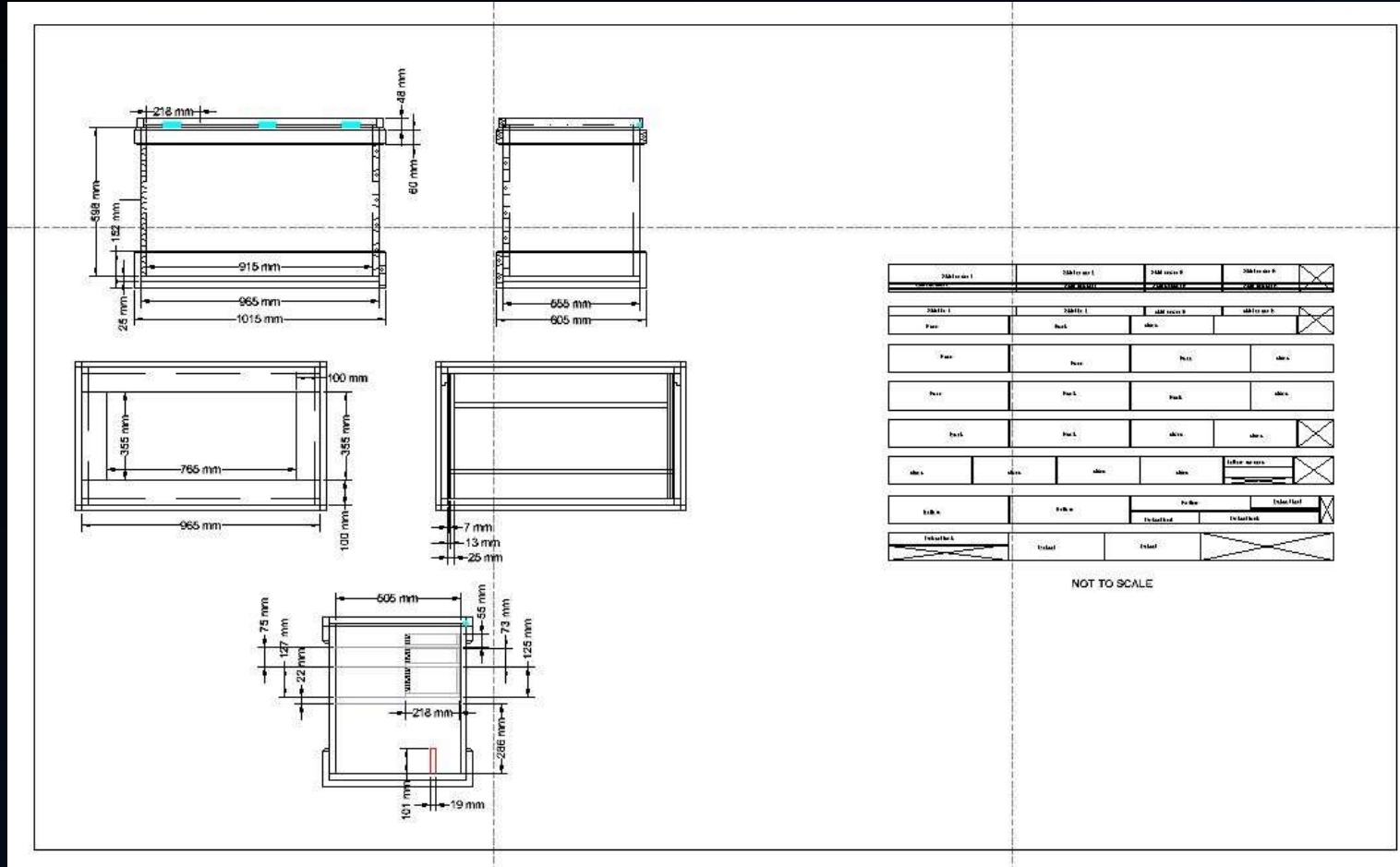

Dovetail the shell

- Laminate panels. Alternating seams. Smile, Frown pattern
- Mark and cutting tails
- Transfer and mark housing for tails
- Dry fit
- Glue up



Skirts:

- Opposite corners dovetailed
- Mark to fit
- U-shape and fit
- Chamfer
- Dust seal skirt at top



Bottom

- Tongue and groove
- Width, stronger than in length
- Nailed / Screwed on



Lid and hinges

- Frame of lid
- Raised floating panel
- Through mortise and tenon
- Hinges
- Lid skirt



Sliding trays:

- Runners for the trays
- Tray construction – through dovetail
- Nailed on bottoms – easier to replace in the future



Finishing:

